



2022 | 2023 COLLECTION



One-stop solution of gift's & premium

WHO WE ARE

GP Links International Limited is a design and manufacturing company specializing in metal and leather products founded in Hong Kong. Armed with it's own research and development, design, sales and marketing as well as production teams, we have been dedicated to create innovative and premium-quality products and earned a reputation as one of the premier manufacturers in the region.

GP Creations Pte. Ltd. is one of the largest corporate gifts leading supplier founded in Singapore. Armed with it's own research and development, design, sales and marketing as well as production teams, we have been dedicated to create innovative and premium-quality products and earned a reputation as one of the premier suppliers in the region.

In other words, we are able to provide a one-stop solution for all types of metal and leather products, corporate gifts, gift's and premium products accomplished at the lowest cost possible.



Our manufacturing plant is located in Guangdong Province China. Sample making, molding, die-casting, electro-plating, aluminum-plating, color spraying, assembling, logo embossing, silkscreen printing, packing... etc. are carried out in the plant. We have a strong Quality Control team guaranteeing the products are of a high standard.

CREDIT CARD CASES / WALLETS		
Aluminum with plastic made		
PUMECH	02	
BUTTON POP	04	
CROSS	08	
Aluminum made		
VERTALIGN	03-04	
PURE	05	
SIMPLY SLIDE-OUT	07-08	
ACCORDION STYLE	09	
CC SAVE	12	
Genuine leather / Synthetic leather made		
LCLIP	13	
CLIP BASIC, CARD ENVELOPE	16	
TSLEEVE	15	
Genuine leather / Synthetic leather with aluminum made		
BASIC, SAFARI POP-OUT	09	
CREDIT CARD CASES		
Steel made		
CLEAR	11-12	
Genuine leather / Synthetic leather made		
STAND FUNCTION, BRUSTRO SAFE	09	
CARBON		
Carbon fiber PU / Synthetic leather made		
PASSPORT HOLDER, AUTOMOBILE KEY SECURE	19	
Genuine carbon fiber made		
LUGGAGE TAG, KEY HOLDER	20	
CREDIT CARD WALLET	20	
MULTI PURPOSE DOUBLE SIDE CLIP	21	
Genuine carbon fiber with plastic made		
BUTTON POP	21	
Genuine carbon fiber combine with titanium silk made		
COLOURFUL	21	
KEY HOLDERS		
Metal made		
SMART PULL-APART	23	
CLASSIC COLOURS LUGGAGE TAG		
Aluminum made		
CLASSIC COLOUR	23-24	
COLOUR	24	
NOTEPAD / MEMO WITH PEN		
Genuine leather / Synthetic leather made		
FIELD MEMO	26	
FIELD MINI	27	
FROSTED GLITTER	28	
ELECTRONIC ACCESSORIES		
Beech / Walnut wood made		
POWERWIRELESS	30-31	
POWERLIGHTER	32	
Aluminum combine with PP mad made		
ALUPAD	33	

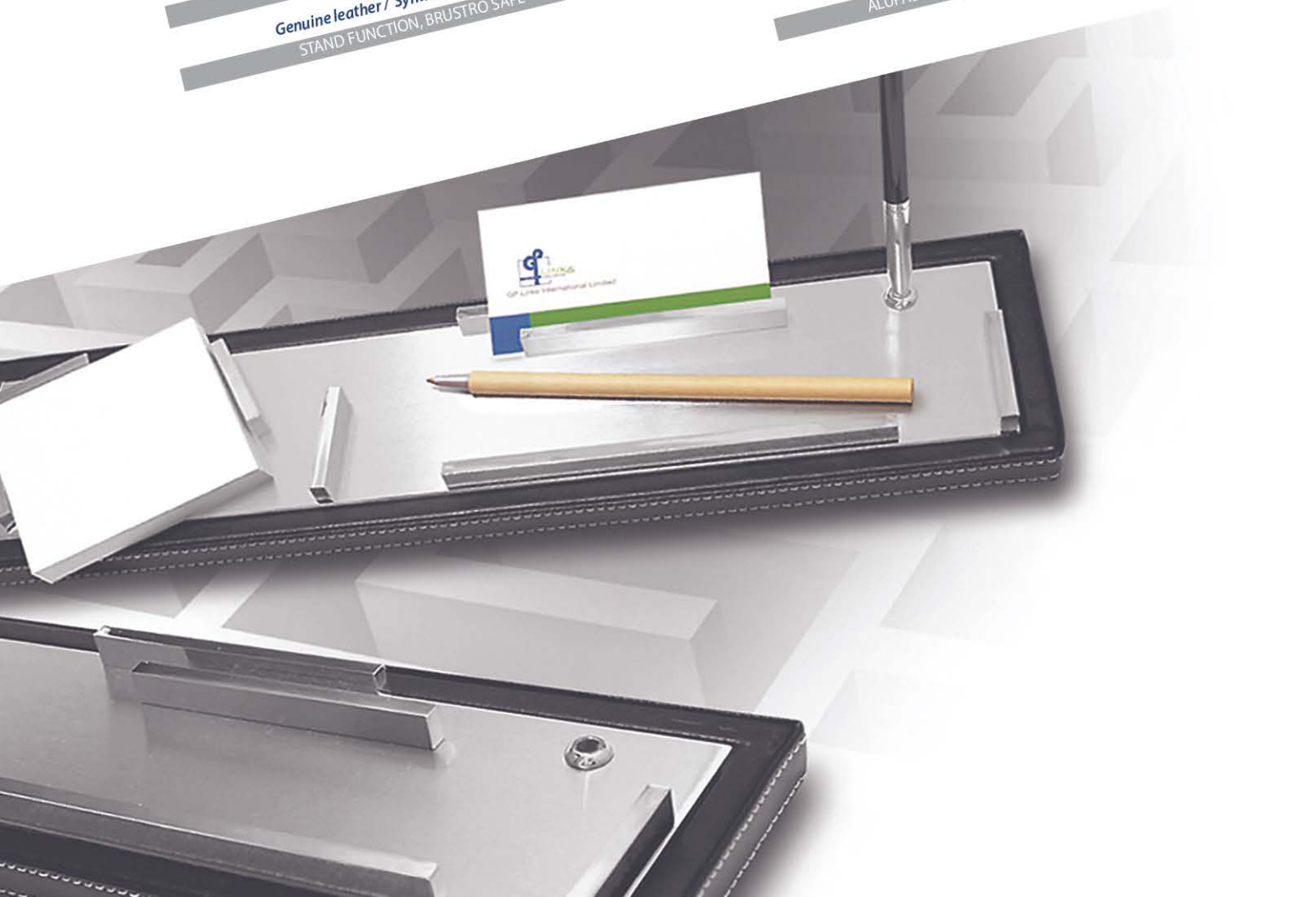

DATA SAFE WITH RFID PROTECTION CREDIT CARD CASES / WALLETS

"PUMECH" credit card wallet is made of aluminium combine with plastic. Wallet is RFID tested and secure; can hold up to 6 cards at any one time, meaning your most precious cards are all secure.

As well as protecting your data, the aluminium housing prevents the deterioration of cards that can often become brittle, split or crack when stored incorrectly.

Your cards are now easier to access by simply press the handy button at the bottom of the case. When press, each card pops up at each separate level so you can easily pick out the one you need. Handy and convenient but ultimately RFID secure.



PUMECH | ALUMINUM with PLASTIC MADE



PUMECH
CCC1012-BLACK
106.7 x 62.5 x 9.2mm



PUMECH
CCC1012-GRAY
106.7 x 62.5 x 9.2mm



PUMECH
CCC1012-SILVER
106.7 x 62.5 x 9.2mm



PUMECH
CCC1012-GOLD
106.7 x 62.5 x 9.2mm



PUMECH
CCC1012-RED
106.7 x 62.5 x 9.2mm



Pop-out | Simply pushing the handy button at the bottom of the case that hold up to 6-7 cards

VERTALIGN | ALUMINUM MADE



VERTALIGN
CCC8281-BLACK
100.6 x 62.9 x 9.2mm



VERTALIGN
CCC8281-GRAY
100.6 x 62.9 x 9.2mm



VERTALIGN
CCC8281-SILVER
100.6 x 62.9 x 9.2mm



VERTALIGN
CCC8281-GOLD
100.6 x 62.9 x 9.2mm



VERTALIGN
CCC8281-RED
100.6 x 62.9 x 9.2mm



VERTALIGN
CCC8281-BLUE
100.6 x 62.9 x 9.2mm



Pop-out | Simply pushing the handy lever at the bottom of the case that hold up to 6-7 cards



PURE | ALUMINUM MADE



With money clip attached

Aluminium credit card case is RFID tested and secure. Can hold up to 6 cards at any one time, meaning your most precious cards are all secure.

As well as protecting your data, the aluminium housing prevents the deterioration of cards that can often become brittle, split or crack when stored incorrectly.

Your cards are now easier to access by simply pushing the handy lever at the bottom of the case. When pushed, each card pops up at each separate level so you can easily pick out the one you need. Handy and convenient but ultimately RFID secure.



Pop-out | Simply pushing the handy lever at the bottom of the case that hold up to 6-7 cards and clip are hold up to 1-20 bills

PURE CLIP
 CCC01056CLIP-BLACK
 100.6mm x 62.9mm x 9.2mm

PURE CLIP
 CCC01056CLIP-SILVER
 100.6mm x 62.9mm x 9.2mm

Without money clip attached

Pop-out | Simply pushing the handy lever at the bottom of the case that hold up to 6-7 cards



PURE
CCC01056-BLACK
100.6mm x 62.9mm x 9.2mm



PURE
CCC01056-GRAY
100.6mm x 62.9mm x 9.2mm



PURE
CCC01056-SILVER
100.6mm x 62.9mm x 9.2mm



PURE
CCC01056-GOLD
100.6mm x 62.9mm x 9.2mm



PURE
CCC01056-RED
100.6mm x 62.9mm x 9.2mm



PURE
CCC01056-BLUE
100.6mm x 62.9mm x 9.2mm

BUTTON POP | ALUMINUM with PLASTIC MADE



"BUTTON POP" credit card case is RFID tested and secure. Can hold up to 6 cards at any one time, meaning your most precious cards are all secure.

Your cards are now easier to access by simply press the button at the side of the case. When press, each card pops up at each separate level so you can easily pick out the one you need.



**REFLECTION
BUTTON POP**

CCC1002-BLACK-RF
95mm x 64mm x 10mm

**REFLECTION
BUTTON POP**

CCC1002-SILVER-RF
95mm x 64mm x 10mm



BUTTON POP

CCC1002-BLACK
95mm x 64mm x 10mm

BUTTON POP

CCC1002-SILVER
95mm x 64mm x 10mm



BUTTON POP

CCC1002-WOOD
95mm x 64mm x 10mm

Pop-out | Simply pushing the handy lever at the bottom of the case that hold up to 6-7 cards

SIMPLY SLIDE-OUT | ALUMINUM MADE



The "Push Slider" RFID protection card case can perfectly block unwanted RFID scanners, includes RFID blocking technology to prevent unauthorized access to personal information, designed to block RFID readers from scanning your credit cards, debit cards, shopping and/or club cards, driver's license or ID card.

CONVENIENCE:

Aluminum card case is very small and light, easy to carry for a day to day traveling or for business occasion, perfect for any cards you want.

SMART DESIGN:

With a push all cards slide out gradually. The cards will not fall out, a perfect card case. No problem to keep it in your back pocket. No breaking, no bending which is can store 5-7 credit cards size cards or 15 business cards.

Slide-out | Slide-out design that hold up to 5-7 cards or 15 business cards



PUSH SLIDER

CCC8081-BLACK
95.2mm x 62.9mm x 9.2mm



PUSH SLIDER

CCC8081-SILVER
95.2mm x 62.9mm x 9.2mm



PUSH SLIDER

CCC8081-GRAY
95.2mm x 62.9mm x 9.2mm



PUSH SLIDER

CCC8081-GOLD
95.2mm x 62.9mm x 9.2mm



PUSH SLIDER

CCC8081-RED
95.2mm x 62.9mm x 9.2mm



PUSH SLIDER

CCC8081-BLUE
95.2mm x 62.9mm x 9.2mm

DATA SAFE WITH RFID PROTECTION CREDIT CARD CASES / WALLETS

The accordion style credit card case is made of aluminum and has 6 card slots, which effectively protects the security of your credit card information.

LIGHTWEIGHT:

Pocket size, aluminum credit card case is also suitable for storing business cards, credit cards, debit cards, shopping and/or club cards, driver's license or ID card, very portable, and can be placed in the back or front pocket.

CAPACITY:

A credit card case with 6 card slots design can meet the daily needs of your card.

SIMPLE DESIGN:

Locking easy for opening and closing, latches safely and securely when not in use.



ACCORDION STYLE | ALUMINUM MADE



Checked



CHECKED

CCC512-CHECKED-SILVER
96.9mm x 69.6mm x 16.6mm



CHECKED

CCC512-CHECKED-BLACK
96.9mm x 69.6mm x 16.6mm



CHECKED

CCC512-CHECKED-BROWN
96.9mm x 69.6mm x 16.6mm



CHECKED

CCC512-CHECKED-GOLD
96.9mm x 69.6mm x 16.6mm



CHECKED

CCC512-CHECKED-RED
96.9mm x 69.6mm x 16.6mm



Inside | 6 card slots

Wave



WAVE

CCC512-WAVE-SILVER
96.9mm x 69.6mm x 16.6mm



WAVE

CCC512-WAVE-BLACK
96.9mm x 69.6mm x 16.6mm



WAVE

CCC512-WAVE-BROWN
96.9mm x 69.6mm x 16.6mm



WAVE

CCC512-WAVE-GOLD
96.9mm x 69.6mm x 16.6mm



WAVE

CCC512-WAVE-RED
96.9mm x 69.6mm x 16.6mm



Inside | 6 card slots

Original



ORIGINAL

CCC512-SILVER
96.9mm x 69.6mm x 16.6mm



ORIGINAL

CCC512-BLACK
96.9mm x 69.6mm x 16.6mm



ORIGINAL

CCC512-BROWN
96.9mm x 69.6mm x 16.6mm



ORIGINAL

CCC512-GOLD
96.9mm x 69.6mm x 16.6mm



ORIGINAL

CCC512-RED
96.9mm x 69.6mm x 16.6mm

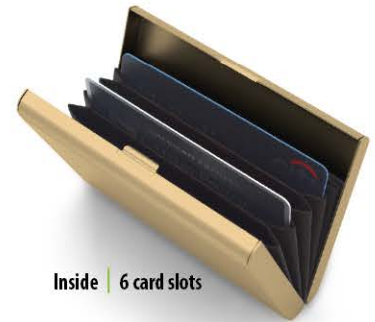

Inside | 6 card slots

CROSS | ALUMINUM with PLASTIC MADE



Open | Simply pull housing that holds up to 6 cards



CROSS

CCC1121-BLACK-GP
105mm x 68mm x 16mm



CROSS

CCC1121-GREEN-GP
105mm x 68mm x 16mm

Protect your identity from wou hieves with this GPLUS's "Cross" credit card wallet. They are made of aluminum combine with plastic and prevent RFID scanning of your cards to gain access to information that could be used against you. The credit card wallet has simply pull function to make it easy to access any cards when you are ready to pay for purchases. Furthermore, it is small enough to fit in either a purse or pocket so you can carry it everywhere with you.

The hard wallet prevents your cards from getting demagnetized. In addition, it protects the cards from getting bent or damaged in other ways. This modern-looking wallet provides both function and style for the user.



CC SAVE | ALUMINUM MADE



This wallet has everything you need, money clip and a place to carry the credit cards, debit cards, shopping and/or club cards, driver's license, ID card and others important private property safely.

The credit card wallet is made by aluminum or carbon fiber material which is better and lighter than alloy. A slim, light body, fashionable and convenient appearance, RFID blocking protection design. Let everyone be free from the heavy purse strings and apply to everyone. Credit card wallet with money clip 2 in 1: It actually holds 1-20 cards comfortably, in addition to 1-20 bills.



REFACTION

CCC5281
86mm x 55mm x 9mm



PURSAND

CCC3081
86mm x 55mm x 9mm



Rear | Money clip
are hold up to 1-20
bills

CLEAR | STEEL MADE



Business cards are essential if you want to introduce yourself and leave a lasting impression. And an individual card case is always impressive. Take this one - made of steel with attractive decoration.

Inside | Business card case,
metal, flat & shiny surface
that are hold up to 11 cards

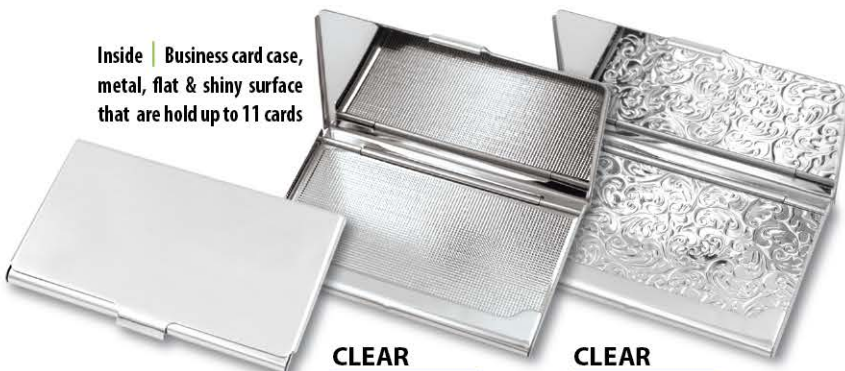

CLEAR

NCC033
95mm x 59mm x 6 mm

CLEAR

NCC034
95mm x 59mm x 6 mm

CLEAR

NCC033-GOLD
95mm x 59mm x 6 mm

GENUINE LEATHER / SYNTHETIC LEATHER CREDIT CARD CASES

The classic in a dual role - as an GPLUS business card case that doubles as a practical card dispenser which can be set up at two different angles. It offers a classically sleek and refined look, with a material mix of synthetic leather and burnished stainless steel. The only question remaining is: do you lay your cards on the desktop, or stand them there? It's up to you!

2 in 1:

As an elegant case and at the same time as a practical business card dispenser, for tilting at two angles.

DURABLE:

For convenient storage of any business cards, credit cards, shopping and/or club cards, driver's license or ID card.

LIGHTWEIGHT:

Fits in any pocket, trouser pocket, shirt pocket, etc. - very easy and handy.

SIMPLE DESIGN:

With magnetic closure and adjustable tilt function.



STAND FUNCTION | SYNTHETIC LEATHER MADE



JEANS

NCC341-JEANS-GP
96mm x 65mm x 14mm



STONE

NCC341-STONE-GP
96mm x 65mm x 14mm



WOOD

NCC341-WOOD-GP
96mm x 65mm x 14mm



Stand | With magnetic closure and adjustable tilt function

BRUSTRO SAFE | SYNTHETIC LEATHER MADE



GPLUS's "Brustro Safe" is a stylish credit card case that gets its distinct look by mixing stainless steel and synthetic leather, resulting in a brush stroke-like appearance but without the heft. The "Brustro Safe" can hold approximately 6 credit card size cards or 15 business cards has the added benefit of RFID protection, blocking would-be wireless thieves from trying to steal your personal information.



BRUSTRO SAFE

NCC029-BEIGE-GP
95.8mm x 63.7mm x 16.6mm



Open | With magnetic closure that hold up to 6 credit cards or 15 business cards





BRUSTO SAFE

NCC029-BLACK-GP
95.8mm x 63.7mm x 16.6mm



BRUSTO SAFE

NCC029-RED-GP
95.8mm x 63.7mm x 16.6mm



Open | With magnetic closure that hold up to 6 credit cards or 15 business cards



BRUSTO SAFE

NCC029-BLUE-GP
95.8mm x 63.7mm x 16.6mm

LCLIP | GENUINE LEATHER MADE



GPLUS's "LClip" wallet design combines the best minimalist and functions from other wallets. Genuine leather, stainless steel with an unique design of pull tab, this wallet is a perfect combination of form and function.

Brushed stainless steel money clip allows you to comfortably carry everything you need to get through the day. Fits to carry your cash in fastened money clip meant to be stationary inside this slim profile.

Open | With an unique design of pull tab and brushed stainless steel money clip that is a perfect combination



LCLIP

CCCC09-RED
104.5mm x 69.3mm x 17mm



LCLIP

CCCC09-BLACK
104.5mm x 69.3mm x 17mm

LCLIP

CCCC09-WHITE
104.5mm x 69.3mm x 17mm



CLIPBASIC | SYNTHETIC LEATHER MADE



CLIPBASIC

CCC009PU-BLUE
104.5mm x 69.3mm x 17mm



Open



CLIPBASIC

CCC009PU-BLACK
104.5mm x 69.3mm x 17mm



Open

CARD ENVELOPE | GENUINE LEATHER MADE



Open | Lightweight design with magnetic closure that hold up to 12 business cards



CARD ENVELOPE

NCC028-BLACK
107mm x 63mm



CARD ENVELOPE

NCC028-RED
107mm x 63mm



CARD ENVELOPE

NCC028-BEIGE
107mm x 63mm

DATA SAFE - SYNTHETIC LEATHER CREDIT CARD WALLETS

The GPLUS's "Basic" credit card wallet is compact in size and surprisingly large in storage capacity. With an unique design of pull tab and magnetic closure, it fits every pocket.

Your cards are now easier to access by simple motion, ready for immediate use. The aluminium protects from bending, breaking and unwanted wireless communication.

"Basic" is a timeless all-purpose synthetic leather with a natural matte finish that fits every style. So its no surprise that this leather is a lasting favourite.



BASIC | SYNTHETIC LEATHER with ALUMINUM MADE



BASIC
CCC008PU-RFID-RED-GP
104.5mm x 69.3mm x 19.7mm



BASIC
CCC008PU-RFID-BROWN-GP
104.5mm x 69.3mm x 19.7mm



Pop-out | Simply pushing the handy lever at the bottom of the case that hold up to 6-7 cards



BASIC
CCC008PU-RFID-BLACK-GP
104.5mm x 69.3mm x 19.7mm



Open | With an unique design of pull tab and magnetic closure, it fits every pocket

SAFARI POP-OUT | SYNTHETIC LEATHER with ALUMINUM MADE



SAFARI POP-OUT
CCC011PU-RFID-BLACK-GP
106.7mm x 72.5mm x 11.8mm



SAFARI POP-OUT
CCC011PU-RFID-GREEN-GP
106.7mm x 72.5mm x 11.8mm



Rear | Money clip are hold up to 1-20 bills



SAFARI POP-OUT
CCC011PU-RFID-RED-GP
106.7mm x 72.5mm x 11.8mm



SAFARI POP-OUT
CCC011PU-RFID-BLUE-GP
106.7mm x 72.5mm x 11.8mm

GPLUS's "Safari Pop-out" credit card wallet that gets its refine look by combine with aluminium and synthetic leather sleeve. Can hold up to 6 cards at any one time, in addition clip to 1-10 bills; meaning your most precious cards are all secure. The "Safari Pop-out" also RFID tested and secure.

The GLPUS's "TSleeve" is the slimmest style in the GPLUS. It can be used as a business card holder, or even as a full-time wallet for those who have a black belt in slimming their pocket contents.

The main section features a pull tab for easy storage of cards and money, while the outside pockets can be used for quick-access items.



TSLEEVE | SYNTHETIC LEATHER MADE



TSLEEVE
CCC010-BLACK-GP
106.9mm x 71.1mm



TSLEEVE
CCC010-BLUE-GP
106.9mm x 71.1mm



TSLEEVE
CCC010-BROWN-GP
106.9mm x 71.1mm

REAR | With special features of pull tab for easy storage of cards and bills



TSLEEVE
CCC010-BLACK-GP
106.9mm x 71.1mm

CARBON FIBER PU / SYNTHETIC LEATHER PASSPORT HOLDERS

GPLUS's "Travel Carsafe" RFID blocking passport holder is made with carbon fiber texture PU / synthetic leather and including 4 slots (1 for passport, 2 for cards and 1 for boarding pass.) The blocking technology in this holder blocks RFID frequencies to help protect your passport, credit cards and ID cards.

The ultra slim and lightweight design, well in a pocket or backpack.
This is the perfect holder for travel.



LONDON



NEW YORK



TOKYO



MOSCOW



TRAVEL CARSAFE | CARBON FIBER TEXTURE PU MADE



TRAVEL CARSAFE

PHR001-Yellow-GP
145.4mm x 109.3mm



TRAVEL CARSAFE

PHR001-RED-GP
145.4mm x 109.3mm



Inside | Separate sections for passport, tickets and cards with RFID protection



TRAVEL CARSAFE

PHR001-BLUE-GP
145.4mm x 109.3mm



TRAVEL CARSAFE

PHR001-GREEN-GP
145.4mm x 109.3mm

AUTOMOBILE KEY SECURE | CARBON FIBER TEXTURE PU MADE



AUTOMOBILE KEY SECURE

KH90
125mm x 80mm

Open | Inner Layer provides a complete signal blocker for vehical key fob

"Automobile Key Secure" is a fashionable design made with carbon fiber texture PU and nano inner layer provides a complete signal blocker for your vehicle key fob. This prevents thieves from picking up and relaying signals from your key, to shield against break-ins and keyless ignition theft.

Luggage tag



LUGGAGE TAG
LT2430-GP
85mm x 54mm

Rear

Key holder



Rear | Belt clip attached



KEY HOLDER
KH1330-GP
74mm x 30mm x 14mm

Credit card wallet with RFID protection



Without money clip attached



CREDIT CARD WALLET
CCC3081(W/O CLIP)
86mm x 55mm x 9mm

With money clip attached



CREDIT CARD WALLET
CCC3081
86mm x 55mm x 9mm



Rear | Money clip are hold up to 1-20 bills

BUTTON POP credit card case



Pop-out | Simply pushing the handy lever at the bottom of the case that hold up to 6-7 cards

BUTTON POP

CCC1002-CF
95mm x 64mm x 10mm



MULTI PURPOSE DOUBLE SIDE CLIP

MCP6130-GP
72.3mm x 38.7mm x 15.4mm

Front | Multi purpose design which are hold up to banknotes, business cards, debit cards, shopping and/or club cards, driver's license or ID card

Multi purpose double side clip

COLOURFUL | CARBON FIBER COMBINE with TITANIUM SILK MADE



COLOURFUL

MCP1720-BLUE-GP
72.3mm x 38.7mm x 11.9mm

COLOURFUL

MCP1720-RED-GP
72.3mm x 38.7mm x 11.9mm

Front | Money clip are hold up to 1-20 bills



COLOURFUL

MCP1720-YELLOW-GP
72.3mm x 38.7mm x 11.9mm



DURABLE • METAL KEY HOLDERS

When you're handing off your car keys at a valet parking station, you probably don't want to hand off the entire keyholder.

Sure, it's probably just paranoia, since the valet parking staff are unlikely to drive your car to your house, use your house key to get in, then rob you while you're at a restaurant or party. Still, most people don't like parting with more keys than necessary. And that's not just when they're handing off keys to valet parking staff.

Fortunately, there's a keyholder with a unique design that allows you to easily separate some keys from others.

SMART PULL-APART | METAL MADE



SMART PULL-APART

KH75173-BLACK
102mm x 23mm x 8mm



SMART PULL-APART

KH75173-RED
102mm x 23mm x 8mm

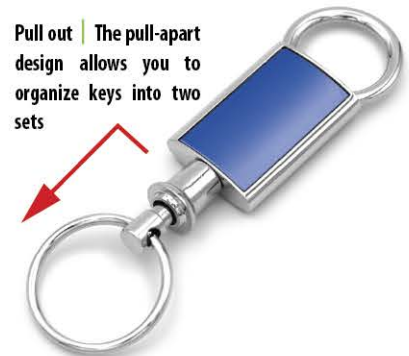

Pull out | The pull-apart design allows you to organize keys into two sets

SMART PULL-APART

KH75173-BLUE
102mm x 23mm x 8mm

CLASSIC COLOURS LUGGAGE TAG | ALUMINUM MADE

Don't Leave Home Without Luggage Tags!

Luggage tags are one of those basic travel needs that you never really think about until suddenly they matter - like when your bags get lifted off the luggage carousel by someone who isn't you.

Luggage tags are an affordable and surprisingly important part of travel preparation. For safety, identification, and theft protection, luggage tags are essential.



CLASSIC COLOUR

LT392-BLUE
80mm x 41mm x 2mm



CLASSIC COLOUR

LT392-BLACK
80mm x 41mm x 2mm

CLASSIC COLOUR

LT392-GREEN
80mm x 41mm x 2mm



CLASSIC COLOUR
LT392-RED
80mm x 41mm x 2mm



CLASSIC COLOUR
LT392-PINK
80mm x 41mm x 2mm



CLASSIC COLOUR
LT392-ORANGE
80mm x 41mm x 2mm



CLASSIC COLOUR
LT393-RED
75mm x 44mm x 2mm



CLASSIC COLOUR
LT393-PINK
75mm x 44mm x 2mm



CLASSIC COLOUR
LT393-ORANGE
75mm x 44mm x 2mm



CLASSIC COLOUR
LT393-GREEN
75mm x 44mm x 2mm



CLASSIC COLOUR
LT393-BLUE
75mm x 44mm x 2mm



CLASSIC COLOUR
LT393-BLACK
75mm x 44mm x 2mm



CLASSIC
LT391-01-SILVER
85mm x 54mm x 2mm



CLASSIC
LT391-SILVER
80mm x 41mm x 4mm



CLASSIC
LT390-SILVER
75mm x 31mm x 2mm

SYNTHETIC LEATHER NOTEPAD / MEMO WITH PEN

Use our pocket-size synthetic leather GPLUS "Field Memo" to take notes and keep them organized.

Our pocket briefcase is a handy travel companion that's also a card holder. It dispenses fresh 2 cards and keeps completed ones separate.



FIELD MEMO | SYNTHETIC LEATHER MADE



FIELD MEMO

NP001-GRAY-GP
154mm x 103.2mm x 10.3mm



FIELD MEMO

NP001-BLUE-GP
154mm x 103.2mm x 10.3mm



FIELD MEMO

NP001-RED-GP
154mm x 103.2mm x 10.3mm



Open | Both memo pad and ballpoint pen are included



Rear | 2 card holders

FIELD MEMO

NP001-GREEN-GP
154mm x 103.2mm x 10.3mm



FIELD MINI | SYNTHETIC LEATHER MADE

A slim size of synthetic leather GPLUS's "Field Mini" to take notes and keep them organized.

Stainless steel made case with blank memo pad, card compartment, synthetic leather cover with and holds a ballpoint pen. Elegant and strong.

At home in the digital world and looking for a dash of analogue style? Then you can share your thoughts with note.

The "Field Mini" has everything you need: blank memo pad, ballpoint pen and - just in case - an additional card compartment. There's no more stylish way to show your individuality.



FIELD MINI

NP002-GREEN-GP
71.6mm x 110.7mm x 10.7mm

FIELD MINI

NP002-BLACK-GP
71.6mm x 110.7mm x 10.7mm



FIELD MINI

NP002-Red-GP
71.6mm x 110.7mm x 10.7mm



FIELD MINI

NP002-ORANGE-GP
71.6mm x 110.7mm x 10.7mm

Front & Open | Card compartment, memo pad (included) with and holds a ballpoint pen (included)



Without card compartment



FROSTED GLITTER

NP478ME-GREY-GP
71.6mm x 110.7mm x 10.7mm



FROSTED GLITTER

NP478ME-BLUE-GP
71.6mm x 110.7mm x 10.7mm



FROSTED GLITTER

NP478ME-PINK-GP
71.6mm x 110.7mm x 10.7mm



FROSTED GLITTER

NP478ME-GOLD-GP
71.6mm x 110.7mm x 10.7mm

**Front & Open | Memo pad (included) with
and holds a ballpoint pen (included)**

BEECH / WALNUT WOOD WIRELESS CHARGER WITH DIGITAL TIMEPIECE

The GPLUS "POWERWIRELESS" wireless charger station with digital timepiece, which can provide wireless charge devices like iPhone, Apple Watch and AirPods. Or Samsung's products.

Beech Wood / Walnut Wood minimalist design, solid and reliable charging experience, sucks in one tap and fits snugly in place. Quickly charge your phone without the shackles of the charging cable; enjoy seamless magnetic calibration and wireless charging on iPhone 12/13/14, Apple Watch and AirPods. Or Samsung's products.

The wireless charger station features 3 Qi-compatible. Simultaneously powers iPhone 12/13/14 (15W), Apple Watch (5W) and AirPods (5W) 3-in-1 charging experience. Or Samsung's products.

It is a wooden and portable design with digital timepiece. Synthetic leather foldable stand is easy for charging and viewing and can be folded for storage and portability.





Front | Wireless charger station with digital timepiece



Rear | Synthetic leather foldable stand



POWERWIRELESS
WC80-IP-BEECH-GP
170mm x 138mm x 24.7mm
(Apple available)

POWERWIRELESS
WC80-SAM-BEECH-GP
170mm x 138mm x 24.7mm
(Samsung available)

SPECIFICATION

Product size:	170 x 138 x 24.7mm
Material:	Beech wood+Metal+Synthetic leather
Input (USB-C/Type-C):	9V/2A(Quick Charge)
Wireless output :	Wireless 1: 5W 7.5W 15W(MAX) <for iPhone/Samsung Phone> Wireless 2: 5W <for AirPods/Earphone> Wireless 3: 2W <for Apple Watch/Watch>
Weight:	335g

NOTE:

QC3.0/2.0 Quick Charge wall adapter (≥18W) required for Fast Charge Mode, Otherwise it will cause unstable charging.



RoHS CE FC



Front | Wireless charger station with digital timepiece



Rear | Synthetic leather foldable stand



POWERWIRELESS

WC80-IP-WALNUT-GP
170mm x 138mm x 24.7mm
(Apple available)

POWERWIRELESS

WC80-SAM-WALNUT-GP
170mm x 138mm x 24.7mm
(Samsung available)

SPECIFICATION

Product size:	170 x 138 x 24.7mm
Material:	Walnut wood+Metal+Synthetic leather
Input (USB-C/Type-C):	9V/2A(Quick Charge)
Wireless output :	Wireless 1: 5W 7.5W 15W(MAX) <for iPhone/Samsung Phone> Wireless 2: 5W <for AirPods/Earphone> Wireless 3: 2W <for Apple Watch/Watch>
Weight:	335g

NOTE:

QC3.0/2.0 Quick Charge wall adapter (≥18W) required for Fast Charge Mode, Otherwise it will cause unstable charging.

SPECIFICATION

Product size:	106 x 23 x 23mm
Material:	Aluminum+ABS
Capacity Range:	2500mAh
Battery Type:	18650 Li-ion Battery
Input:	DC5V 1000A
Output:	DC5V 1000A
Product Weight:	85g
Working Temperature:	0°C~45°C
Accessories:	Micro USB Cabel, Carabiner

GPLUS's "PowerLight" click on click off LED flashlight with strong aluminum housing and carabiner for easy attachment to a bicycle handle bar or stroller handle bar. With emergency powerbank function, it is definitely a reliable companion when you take part in outdoor activities.



POWERLIGHT | ALUMINUM MADE



POWERLIGHT
EC001-SILVER-GP
106mm x 23mm x 23mm



POWERLIGHT
EC001-Red-GP
106mm x 23mm x 23mm



POWERLIGHT
EC001-BLUE-GP
106mm x 23mm x 23mm



Emergency Power | With powerbank 2500mAh function



POWERLIGHT
EC001-BLACK-GP
106mm x 23mm x 23mm



ALUPAD
MP003-BLACK-GP
220mm x 180mm



ALUPAD
MP003-GOLD-GP
220mm x 180mm



ALUPAD
MP003-SILVER-GP
220mm x 180mm

The GPLUS's "Alupad" is a special design made of aircraft grade aluminum alloy combine with PP. Micro stand blasting surface with quick and accurate control perfect for gaming and work .Highly fashion stylish mouse pad compatible with all the mouse on the market, such as, laser, optical, and mechanical mice especially for wireless mouse.

iPhone, iPad, Apple Watch and AirPods are registered trademarks of Apple Inc. Android, Google, Google Docs, Picasa, Gmail and Google Play are trademarks of Google Inc. IOS is a trademark or registered trademark of Cisco in the U.S. and other countries and is used under license.

Samsung and the Samsung logo are trademarks of Samsung Electronics Co., Ltd.

GPLUS and GAEA are registered trademarks of GP Links International Limited.

All other brand or product names are trademarks of their respective companies or organizations.

All product specifications are correct at the time of print. GP LINKS or GP CREATIONS reserves the right to make any changes necessary. Colour images may vary from the product due to printing quality. Errors and omissions excepted.

HONG KONG

GP Links International Limited

Room 2, 6/F., Lemmi Centre
50 Hoi Yuen Road
Kwun Tong, Kowloon
Hong Kong

info@gplinksgroup.com | info.gplinks@gmail.com

SINGAPORE

GP Creations Pte. Ltd.

111 North Bridge Road
#04-28, Peninsula Plaza
Singapore 179098

cs.gpcreations@outlook.com | cs.gpcreations@gmail.com



www.gplinks.weebly.com